



**CHINA-HWAMDA**

THE CRAFTSMANSHIP OF THE WORLD

中国的华美达,世界的工匠心

**CHINA**  
**HWAMDA**  
第二代高效节能注塑机系列 **MACHINERY**  
M8SII PLASTIC INJECTION MOLDING MACHINE  
MANUFACTURING CO., LTD.

2025年5月修订

**宁波华美达集团有限公司**  
NINGBO HWAMDA GROUP CO., LTD.

地址: 浙江省宁波市小港安居路368号  
Add: Anju Road No.368, Xiao Gang Street,  
Ningbo, Zhejiang, P.R. China  
邮编 (P.C.): 315801  
Http://www.hwamda.com

国内销售  
电话: 0574-86175111  
0574-86176676  
传真: 0574-86176890  
邮箱: info@hwamda.com

International  
Tel: 86-574-86176630  
86-574-86228735  
Fax: 86-574-86228918  
E-mail: sales@hwamda.com



**宁波华美达集团有限公司**  
NINGBO HWAMDA GROUP CO., LTD.



宁波华美达机械制造有限公司地处“中国塑机之都”的浙江省宁波市，是一家专业化生产塑料注射成型机械的高新技术企业，经过不断的技术创新，公司自主研发的系列产品已广泛应用于汽车、电子、医疗、环保、物流、包装等众多注塑生产行业，目前，华美达已经成长为具有雄厚规模实力和竞争能力的中国注塑机行业前列企业。2021年，成立宁波华美达集团有限公司，以集团化经营服务全球客户。

华美达公司现有四大生产制造基地，超过三十万平方米厂房设施，引进各种大型先进精密加工设备，团结了一支高素质的企业管理与技术创新团队。公司一直致力于高效节能型注塑机的开发制造与市场推广，已成功推出有精密伺服注塑机、二板注塑机、全电动注塑机、高速精密注塑机、高性能注塑机、清混多色注塑机、PET专用快速注胚系统等多个系列以及各种行业专用型产品。

为贴近客户，公司大力开拓国际市场，在国内外建立60余处完善的销售机构及海外服务中心，华美达注塑机受到了北美、中东、南美、东南亚、欧洲及非洲等各个国家和地区客户的使用和欢迎，建立了面向国际市场的营销体系。

公司通过ISO9001、ISO14001、OHSAS18001管理体系认证以及CE、EAC、KCS和“一带一路”等国际认证，所生产的各系列注塑机均配备世界知名品牌的液压、电器及控制系统，引进国际领先设计理念，通过严格的检验、加工、装配、调试，为客户提供优质的产品与服务。

一流的品质，是华美达执着追求的重要目标。尽力满足顾客需求，以精益求精、开拓进取的企业精神缔造辉煌的未  
来，公司始终坚持“专心专注，做好塑机”的企业理念，为中国注塑机械产业的发展和提高做出自己的贡献。

## 关于华美达 About US



Ningbo Hwamda Machinery Manufacturing Co., Ltd. is a new and high technology enterprise devoted to manufacture plastic injection machine, lying in the "City of China plastic molding machine" - Ningbo, Zhejiang.

Now, Hwamda Company owns four factories with more than three hundred thousand square meters. There are over 700 workers and staff members, holding together a high-quality team of managers and technical team. Our company always devoted to R&D for high efficiency and energy-saving injection molding machine. At present, our main products including servo motor energy saving machines, two platen machines, full electric machines, high speed machine for thin-wall products, twin-color machines, special high speed machine for PET preform and other standard or special injection molding machines.

Following the idea of serving customers, we have established more than 60 perfect sales & service branch in China and abroad. Hwamda machine has sold to many countries such as Russia, Poland, Mexico, India, Sri Lanka, Egypt, Brazil, Peru, Colombia, etc. Hwamda has gradually set up a marketing system covering both the domestic and overseas markets.

Hwamda has passed the ISO9001, ISO14001, OHSAS18001 and CE, EAC, KCS certification. All the series of injection machine are equipped with world famous hydraulic & electric elements and control system. Through strict inspection, assembly and test, Hwamda has provided first-class products and services to customers.

"First-class quality" is what we are pursuing the most. We will try our best to meet the requirements of customers and create even better future. Our company firmly sticks to the idea of "With undivided attention to manufacture excellent plastic injection molding machines", and makes our own contribution for the development and improvement of national plastic industry.



# P

## Provincial High-tech Enterprise Research and Development Center

### 浙江省高新技术企业研发中心 +

华美达一直坚持对技术创新体系的重视与支持，高新技术的研发促进了企业核心竞争力的提升，公司具有国内领先的产品研发中心，已掌握和使用的主要包括有全闭环控制、高效节能控制、低噪音控制、高速注射成型等先进技术。华美达研发中心包括开发中心、检验中心、知识产权中心、标准化小组和试制组，覆盖了机械、电子电力、液压传动、高分子材料等相关领域，研发队伍的整体实力和经验在同行业中处于领先水平。以不断创新的产品技术和研发理念，满足客户对注塑机高速、精密、节能、环保等方面日益提高的生产要求。

Hwamda Machinery persist to cherish and support technology innovation. Our efforts on high-tech innovation and R&D have raised our core competitive. Now, we have mastered and use whole closed-loop control, high efficiency and energy saving control, low-noise control, high-speed injection on our machines. Our R&D center including development center, intellectual property centre, standardized team and trial-produce center, covering mechanical, electronics, electric, hydraulic transmission, polymers etc. The research team ability and experience as leader level in the same industry. With update innovation and research vision, to meet customer gradually update products requests for high speed, precision, energy saving, environmental friendly etc.



## + 专业化、定制化的产品服务 Specialized and Customized Product Services

- 我们一直专注于注塑机械最新技术的研发推广
- 为客户寻求更好的产品解决方案
- 不断追求卓越、突破创新
- Devoted to the new technology research
- Pursue the better product solution for customer
- Keep innovation, reach to new breakthrough



## + 360° 服务 Our Service

华美达在中国主要省市地区广泛建立四十多处完善的销售代理机构，并在北美、中东、南美、东南亚、欧洲等海外市场设置二十余处海外服务中心，建立了面向国际的营销体系。

Hwamda Machinery has more than 40 sales & service branch in major domestic areas, with more than 20 oversea agents including North America, the middle East, South America, Southeast Asia, Europe. We have gradually established an international marketing system.



为全球客户提供360度完善的售前咨询、售中安装调试和培训，以及售后维修的全程追踪服务和网络远程技术支持。

Provide global customers with 360-degree comprehensive pre-sales consultation, in-sale installation, commissioning and training, as well as after-sales maintenance tracking service and network remote technical support.

- 1 热线咨询（产品及技术），可根据客户要求对产品定制设计。  
Hotline consultation for products and technology. We can design machines according to your special requirement.
- 2 提供产品安装调试服务，以及使用知识培训。  
Provide installation and adjustment service and usage training.
- 3 全天候维修服务，整机三包一年。并提供产品升级或改装等其它服务。  
One year guarantee for the whole machines. Also provide machines upgrading and modification service.
- 4 华美达为适应e时代高速发展，利用了最先进的网络平台，让客户在第一时间与在线工程师交流，通过“远程诊断”，获取最及时的解决方案。  
Adapt the quick working steps in e-time, Hwamda Machinery using the advanced network to let customers communicate with online engineers to get timely resolution.



一流的品质，是华美达人执着追求的重要目标。公司所生产的各系列注塑机均配备世界知名品牌的液压、电器及控制系统，引进国际领先设计理念，通过严格的检验、加工、装配、调试，建立起一套完善的质量管理体系，为客户提供优质的产品与服务。

"First-class quality" is what we are pursuing the important target. All the series of injection molding machine are equipped with world famous hydraulic and electric elements and control system. Through strict QC raw material inspection, processing, assembly and debug, set up the complete quality management system, to provide better products and service.



## 原材料检测

### MATERIAL PERFORMANCE DETECTION

材料成分检测、显微组织检测、材料硬度检测、表面粗糙度检测、力学性能测试、加工精度检测、尺寸外观检测

Material Ingredient analyze detection, Microstructure detection, Material hardness detection, Surface roughness detection, Mechanical performance inspection, Machining accuracy detection, Dimension appearance detection

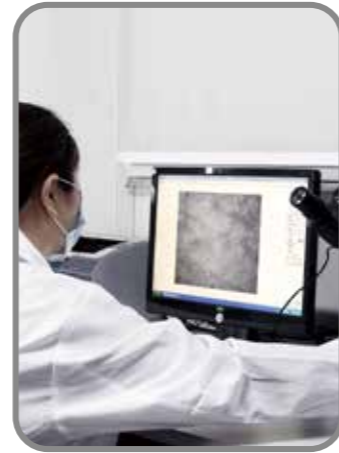

## 装配过程控制

### ASSEMBLE PROCESS CONTROL

液压系统检测、锁模机构检测、注射机构检测、电器安装检测、自动循环无故障检测、安全功能检测、特别工程检测

Hydraulic system control detection, Clamping structure detection, Injection structure detection, Electrical installation detection, Auto-cycle without troubleshoot detection, Safety function detection, Special project detection



## 出厂检验

### DELIVERY INSPECTION

整机外观检验、安全设置检验、整机性能检验、随机备件检验、新增项目检验

Machine appearance inspection, Safety setting inspection, Machine performance inspection, Spare parts inspection, New project inspection



华美达集团现有四大生产基地，超过30万平方米现代化生产厂房，并建有一流的管理中心，通过远程网络监控以及ERP数据链管理，实现生产数据共享、协同制造以及远程管理，具备开发国际先进技术产品的能力。

多年来华美达始终以国际标准为准则，不断发展产品的科技力量。依靠行业领先的软硬件设备，不断引进、消化、吸收国际最先进的工艺技术，并凭借自身的强大研发能力，迅速成为中国塑机行业综合技术和生产规模极具优势企业。

Hwamda Group has four production bases, more than three hundred thousand square meters of modern production plant. We have a first-class management center, through remote network monitoring and ERP data chain management, to achieve production data sharing, collaborative manufacturing and remote management, with the ability to develop international advanced technology products.

We always adhere to the international industry-leading standards, and continually to develop our R&D ability. Continuing to introduce, digest and absorb the most leading technology in plastic machinery industry and with our own strong R&D capability, we have become a very competitive enterprises in China plastic machinery industry both in technology and production scale.

# 四

生产基地(个)

# 300000+

现代化生产厂房(平方米)



更优参数，更长寿命  
更快速度，更高精度  
更好安全性

*SUPERIOR PARAMETERS, LONGER LIFESPAN, FASTER SPEED,  
HIGHER PRECISION, BETTER SECURITY!*



# C

## CLAMPING UNIT

### 锁模单元



运动平稳、快速，采用高刚性模板，拉杆使用寿命更长

Smooth and Fast Movement, High Rigid Platen, Longer Lifespan of Tie Bar

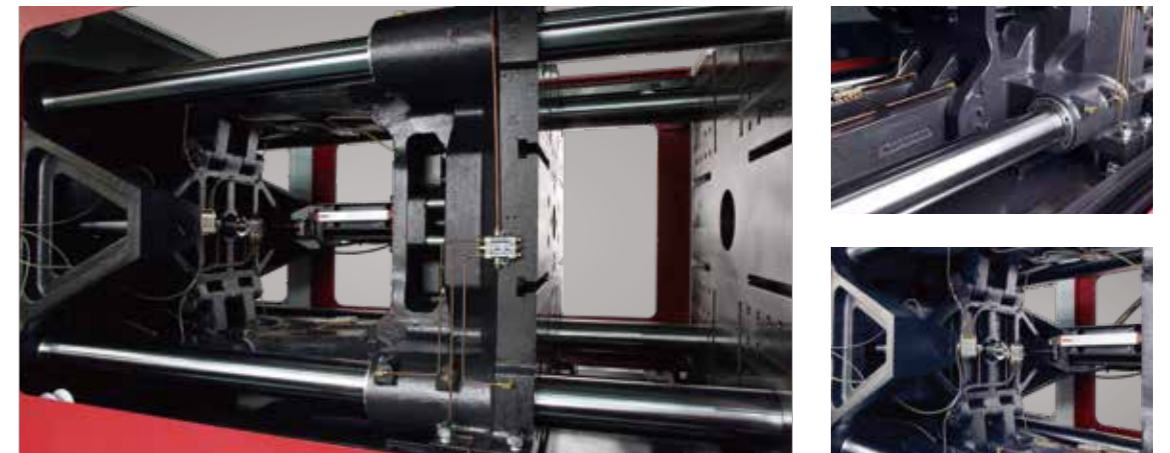

采用在高速机上验证过的中间加强型模板设计，并使用加粗拉杆，经有限元分析优化，使锁模机构具有运动平稳、快速、模板刚性好和拉杆寿命长的优点。

Middle part strengthen design clamping unit and enhance tie bar, after the finite element analysis and optimization, the clamping mechanism has the advantages of smooth and fast movement, good rigidity platen and long lifespan of tie bar.

本系列标配T形槽，方便模具安装和拆卸。液压马达驱动自动调模装置，平稳、快速、高效，节省装模时间。

Standard with T-slot, easy mold mounted. The hydraulic motor drives the automatic mold adjustment device, stable, fast and efficient, and saves the time of mold mounted.



# INJECTION UNIT

## 注射单元



### 优化设计螺杆料筒组件，具备更强塑化能力和更好塑化效果 Optimized Design of Screw and Barrel, With Better Plasticizing Ability and Performance

双缸射胶系统，配合斜排双射移油缸，确保射胶动作平稳。采用线性导轨设计，使注射和储料时阻力更低并且受力均匀，注射动作和储料背压反应更加灵敏，具有更高的注射精度。

Double-cylinder injection system and double carriage cylinder, to make sure the injection movement stable and smoothly. Equipped with guide liner design, with lower resistance. Injection and charge back pressure more fast, with high injection precision.



优化设计螺杆料筒组件，具备更强的塑化能力和更好塑化效果，满足各种特殊产品需求。对注射活塞杆，注射动模板，传动轴等关键部件进行强化，大幅降低活塞杆断裂概率。

Optimize the design of screw and barrel, with stronger plasticizing ability and better plasticizing performance, to meet the different kinds of special products. The key components such as injection piston rod, injection driving platen and coupler are strengthened to greatly reduce the fracture probability of piston rod.

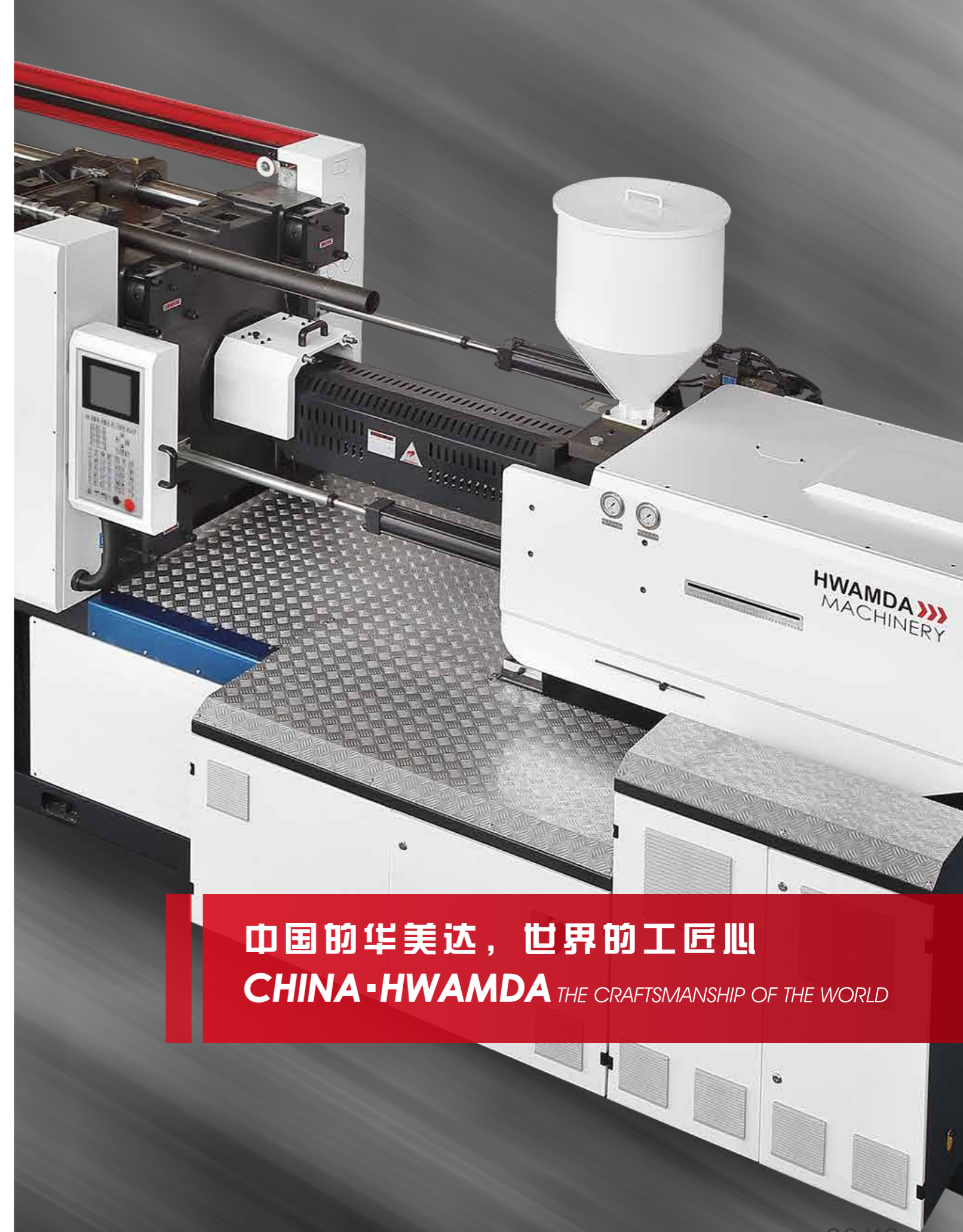

中国的华美达，世界的工匠心  
**CHINA-HWAMDA** THE CRAFTSMANSHIP OF THE WORLD



## 节能高效，响应速度快，压力控制精确 High Precision, Energy-Saving, Quick- Response

采用永磁同步伺服电机和专用伺服驱动器，全数字闭环控制，节能高效，响应速度快，压力控制精确，在低流量时更加稳定。

Sync servo motor and driver, with digital close loop control, energy saving and efficiency ,fast response and precision control, more stable at low flow situation.

动力加大设计，使整机速度更快，有效缩短产品生产周期，提高生产效率。

Increased motor power design, machine faster and more efficiency, shorten the production cycle time, improve production efficiency.



## HYDRAULIC UNIT 液压单元

## ELECTRIC UNIT 电控单元



- 1 标配安全继电器，安全阀，钣金保护按照GB2530国家安全标准设计，增加热总开关保护，五孔插保护，提升整机安全性能。关键元件采用施耐德、ABB、OMRON等进口品牌。
- 2 采用高阶注塑机专用控制器，大规格彩色显示屏，显示清晰，人机友好操作界面。



- 1 Standard with safety relay, safety hydraulic valve and metal cover protection are designed in accordance with GB2530 national safety standards, adding thermal master switch protection and five-hole plug protection to improve the safety performance of the whole machine. The key components are imported brands such as Schneider, ABB, OMRON etc.



- 2 The series equipped with high-performance controller, large LCD display and simple friendly operational interface.



# 技术参数表 SPECIFICATIONS

| 参数                        | PARAMETER                     | UNIT            | HMD90M8-SII |                 |        | HMD130M8-SII |                 |      |      | HMD170M8-SII |                 |      |        |
|---------------------------|-------------------------------|-----------------|-------------|-----------------|--------|--------------|-----------------|------|------|--------------|-----------------|------|--------|
| 国际公认型号                    | International size rating     | —               | 282/90      |                 |        | 445/130      |                 |      |      | 587/170      |                 |      |        |
| 注射装置                      | INJECTION UNIT                |                 | A           | B               | C      | A            | B               | C    | D    | A            | B               | C    | D      |
| 理论注射容量                    | Injection volume(theoretical) | cm <sup>3</sup> | 129         | 163             | 201    | 193          | 215             | 263  | 316  | 239          | 276             | 332  | 441    |
| 注射重量                      | Injection weight(PS)          | g (克)           | 117         | 148             | 183    | 176          | 196             | 239  | 287  | 217          | 252             | 302  | 401    |
|                           |                               | oz (盎司)         | 4.1         | 5.2             | 6.5    | 6.2          | 6.9             | 8.4  | 10.1 | 7.7          | 8.9             | 10.7 | 14.2   |
| 注射速率                      | Injection rate(PS)            | g/s             | 98          | 123             | 152    | 101          | 113             | 138  | 165  | 120          | 140             | 167  | 223    |
| 螺杆直径                      | Screw diameter                | mm              | 32          | 36              | 40     | 36           | 38              | 42   | 46   | 39           | 42              | 46   | 53     |
| 注射压力                      | Injection pressure            | MPa             | 219         | 173             | 140    | 230          | 207             | 169  | 141  | 234          | 202             | 169  | 127    |
| 螺杆长径比                     | Screw L/D ratio               | —               | 22:1        | 19.6:1          | 17.6:1 | 23.5:1       | 22:1            | 20:1 | 18:1 | 23.4:1       | 21.8:1          | 20:1 | 17.3:1 |
| 螺杆行程                      | Screw stroke                  | mm              |             | 160             |        |              | 190             |      |      |              | 200             |      |        |
| 螺杆转速                      | Screw speed                   | r/ min          |             | 0 ~ 300         |        |              | 0 ~ 259         |      |      |              | 0 ~ 243         |      |        |
| <b>合模装置 CLAMPING UNIT</b> |                               |                 |             |                 |        |              |                 |      |      |              |                 |      |        |
| 锁模力                       | Clamping force                | kN              |             | 900             |        |              | 1300            |      |      |              | 1700            |      |        |
| 移模行程                      | Mold opening stroke           | mm              |             | 320             |        |              | 380             |      |      |              | 450             |      |        |
| 模板尺寸                      | Platen size                   | mm              |             | 535 × 535       |        |              | 630 × 610       |      |      |              | 710 × 690       |      |        |
| 拉杆内间距                     | Dist. between tie bars (HxV)  | mm              |             | 360 × 360       |        |              | 430 × 410       |      |      |              | 480 × 460       |      |        |
| 模板最大距离                    | Max.daylight                  | mm              |             | 680             |        |              | 840             |      |      |              | 970             |      |        |
| 容模量(最小—最大)                | Mold thickness(Min—Max)       | mm              |             | 150 ~ 360       |        |              | 150 ~ 460       |      |      |              | 180 ~ 520       |      |        |
| 顶出行程                      | Ejector stroke                | mm              |             | 100             |        |              | 125             |      |      |              | 140             |      |        |
| 顶出力                       | Ejector tonnage               | kN              |             | 31              |        |              | 42              |      |      |              | 50              |      |        |
| <b>动力/电热 POWER UNIT</b>   |                               |                 |             |                 |        |              |                 |      |      |              |                 |      |        |
| 油压系统压力                    | Hydraulic system pressure     | MPa             |             | 16              |        |              | 17.5            |      |      |              | 17.5            |      |        |
| 油泵马达                      | Pump motor power              | kW              |             | 18.7            |        |              | 18.7            |      |      |              | 23              |      |        |
| 电热功率                      | Heater power                  | kW              |             | 8.6             |        |              | 9.4             |      |      |              | 12.5            |      |        |
| 温度控制区数                    | Number of temp control zones  | —               |             | 4               |        |              | 4               |      |      |              | 4               |      |        |
| <b>其它 OTHERS</b>          |                               |                 |             |                 |        |              |                 |      |      |              |                 |      |        |
| 油箱容积                      | Oil tank                      | L (升)           |             | 125             |        |              | 135             |      |      |              | 170             |      |        |
| 外形尺寸(L x W x H)           | Machine dimension(L x W x H)  | m               |             | 4.0 × 1.2 × 1.9 |        |              | 4.5 × 1.4 × 1.9 |      |      |              | 4.9 × 1.4 × 2.1 |      |        |
| 机器重量                      | Machine weight                | Ton             |             | 3.5             |        |              | 4               |      |      |              | 5               |      |        |

## 机器尺寸/MACHINE DIMENSION

|   | HMD90M8-SII | HMD130M8-SII | HMD170M8-SII |
|---|-------------|--------------|--------------|
| A | 1528        | 1629         | 1730         |
| B | 3911        | 4423         | 4892         |
| C | 4016        | 4502         | 4946         |
| D | 1897        | 1908         | 2105         |
| E | 1193        | 1400         | 1448         |

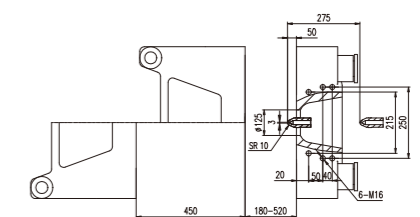
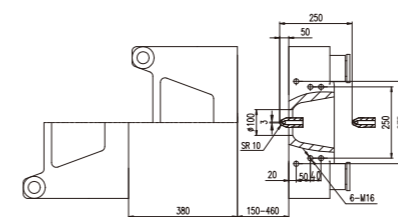
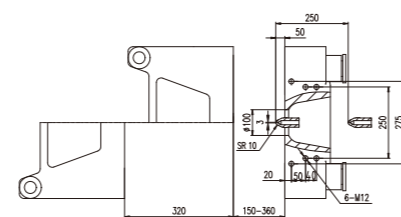
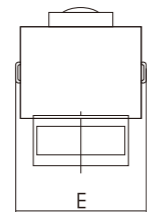
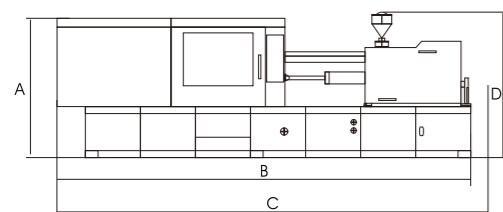
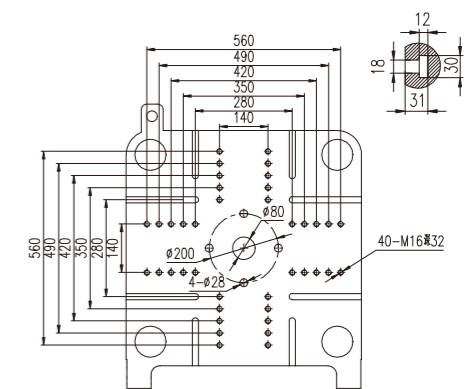
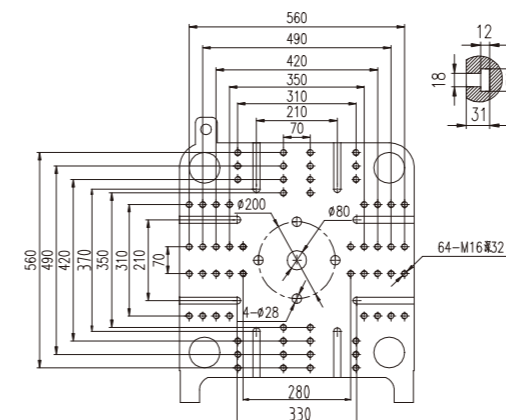
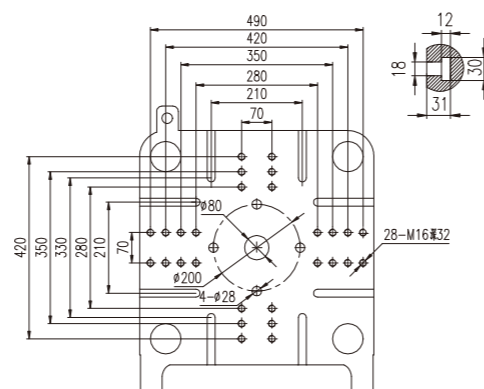

# 技术参数表 SPECIFICATIONS

| 参数                  | PARAMETER                        | UNIT            | HMD218M8-SII    |        |      |        | HMD268M8-SII    |      |        |        | HMD290M8-SII    |      |        |        |
|---------------------|----------------------------------|-----------------|-----------------|--------|------|--------|-----------------|------|--------|--------|-----------------|------|--------|--------|
| 国际公认型号              | International size rating        | —               | 876/218         |        |      |        | 1385/268        |      |        |        | 1385/290        |      |        |        |
| 注射装置                | INJECTION UNIT                   |                 | A               | B      | C    | D      | A               | B    | C      | D      | A               | B    | C      | D      |
| 理论注射容量              | Injection volume(theoretical)    | cm <sup>3</sup> | 399             | 471    | 529  | 678    | 589             | 662  | 848    | 1058   | 589             | 662  | 848    | 1058   |
| 注射重量                | Injection weight(PS)             | g (克)           | 363             | 423    | 482  | 617    | 536             | 602  | 772    | 963    | 536             | 602  | 772    | 963    |
|                     |                                  | oz (盎司)         | 12.8            | 15.1   | 17   | 21.8   | 18.9            | 21.2 | 27.2   | 34     | 18.9            | 21.2 | 27.2   | 34     |
| 注射速率                | Injection rate(PS)               | g/s             | 163             | 192    | 216  | 277    | 197             | 222  | 284    | 355    | 197             | 222  | 284    | 355    |
| 螺杆直径                | Screw diameter                   | mm              | 46              | 50     | 53   | 60     | 50              | 53   | 60     | 67     | 50              | 53   | 60     | 67     |
| 注射压力                | Injection pressure               | MPa             | 220             | 186    | 166  | 127    | 235             | 209  | 163    | 131    | 235             | 209  | 163    | 131    |
| 螺杆长径比               | Screw L/D ratio                  | —               | 24.1:1          | 22.2:1 | 21:1 | 18.5:1 | 24.5:1          | 23:1 | 20.3:1 | 18.3:1 | 24.5:1          | 23:1 | 20.3:1 | 18.3:1 |
| 螺杆行程                | Screw stroke                     | mm              | 240             |        |      |        | 300             |      |        |        | 300             |      |        |        |
| 螺杆转速                | Screw speed                      | r/ min          | 0 ~ 240         |        |      |        | 0 ~ 217         |      |        |        | 0 ~ 217         |      |        |        |
| 合模装置                | CLAMPING UNIT                    |                 |                 |        |      |        |                 |      |        |        |                 |      |        |        |
| 锁模力                 | Clamping force                   | kN              | 2180            |        |      |        | 2680            |      |        |        | 2900            |      |        |        |
| 移模行程                | Mold opening stroke              | mm              | 510             |        |      |        | 560             |      |        |        | 600             |      |        |        |
| 模板尺寸                | Platen size                      | mm              | 780 × 780       |        |      |        | 835 × 835       |      |        |        | 920 × 920       |      |        |        |
| 拉杆内间距               | Dist. between tie bars (HxV)     | mm              | 530 × 530       |        |      |        | 580 × 580       |      |        |        | 630 × 630       |      |        |        |
| 模板最大距离              | Max.daylight                     | mm              | 1060            |        |      |        | 1160            |      |        |        | 1250            |      |        |        |
| 容模量(最小—最大)          | Mold thickness(Min—Max)          | mm              | 200 ~ 550       |        |      |        | 220 ~ 600       |      |        |        | 250 ~ 650       |      |        |        |
| 顶出行程                | Ejector stroke                   | mm              | 140             |        |      |        | 160             |      |        |        | 160             |      |        |        |
| 顶出力                 | Ejector tonnage                  | kN              | 50              |        |      |        | 77              |      |        |        | 77              |      |        |        |
| 动力/电热               | POWER UNIT                       |                 |                 |        |      |        |                 |      |        |        |                 |      |        |        |
| 油压系统压力              | Hydraulic system pressure        | MPa             | 17.5            |        |      |        | 17.5            |      |        |        | 17.5            |      |        |        |
| 油泵马达                | Pump motor power                 | kW              | 31.3            |        |      |        | 36.5            |      |        |        | 36.5            |      |        |        |
| 电热功率                | Heater power                     | kW              | 17.2            |        |      |        | 21.9            |      |        |        | 21.9            |      |        |        |
| 温度控制区数              | Number of temp control zones     | —               | 5               |        |      |        | 6               |      |        |        | 6               |      |        |        |
| 其它                  | OTHERS                           |                 |                 |        |      |        |                 |      |        |        |                 |      |        |        |
| 油箱容积                | Oil tank                         | L (升)           | 270             |        |      |        | 325             |      |        |        | 340             |      |        |        |
| 外形尺寸<br>(L x W x H) | Machine dimension<br>(L x W x H) | m               | 5.5 × 1.6 × 2.1 |        |      |        | 6.2 × 1.7 × 2.3 |      |        |        | 6.4 × 1.8 × 2.4 |      |        |        |
| 机器重量                | Machine weight                   | Ton             | 7               |        |      |        | 9               |      |        |        | 11.5            |      |        |        |

## 机器尺寸/MACHINE DIMENSION

|   | HMD218M8-SII | HMD268M8-SII | HMD290M8-SII |
|---|--------------|--------------|--------------|
| A | 1824         | 1917         | 2013         |
| B | 5450         | 6187         | 6350         |
| C | 5670         | 6265         | 6420         |
| D | 2120         | 2337         | 2412         |
| E | 1633         | 1656         | 1795         |

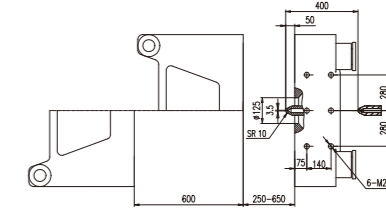
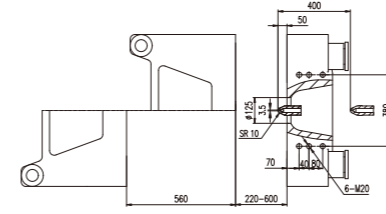
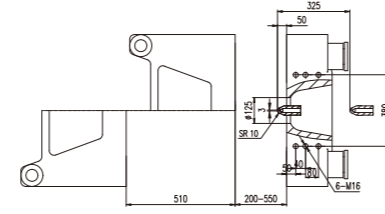
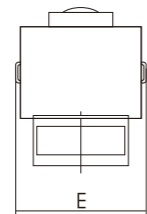
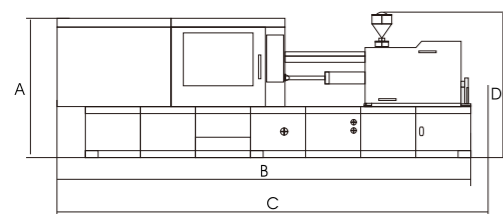
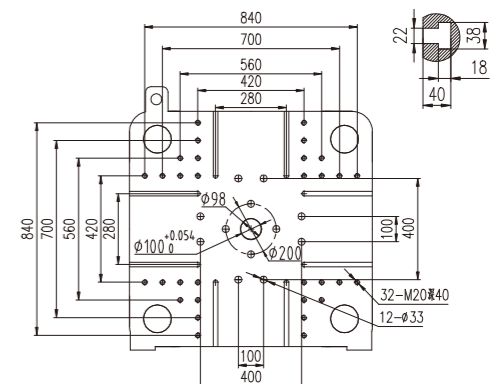
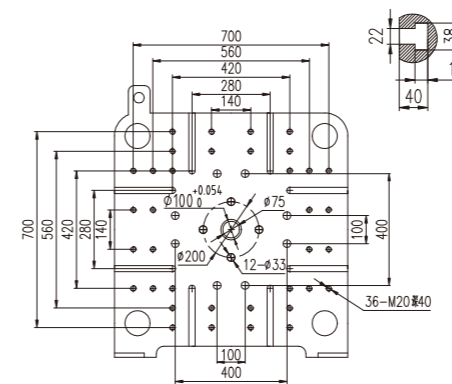
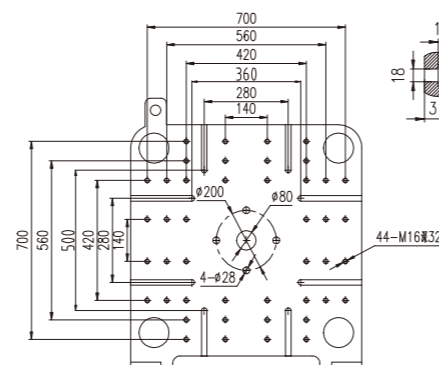

# 技术参数表 SPECIFICATIONS

| 参数                         | PARAMETER                     | UNIT            | HMD310M8-SII    |        |      |        | HMD320M8-SII    |        |        |        | HMD380M8-SII    |      |        |        |
|----------------------------|-------------------------------|-----------------|-----------------|--------|------|--------|-----------------|--------|--------|--------|-----------------|------|--------|--------|
|                            |                               |                 | 1500/310        |        |      |        | 1930/320        |        |        |        | 2674/380        |      |        |        |
| 国际公认型号                     | International size rating     | —               | A               | B      | C    | D      | A               | B      | C      | D      | A               | B    | C      | D      |
| <b>注射装置 INJECTION UNIT</b> |                               |                 |                 |        |      |        |                 |        |        |        |                 |      |        |        |
| 理论注射容量                     | Injection volume(theoretical) | cm <sup>3</sup> | 712             | 848    | 995  | 1154   | 829             | 918    | 1145   | 1435   | 1194            | 1385 | 1590   | 1809   |
| 注射重量                       | Injection weight(PS)          | g (克)           | 648             | 771    | 905  | 1050   | 755             | 836    | 1042   | 1306   | 1087            | 1260 | 1447   | 1646   |
|                            |                               | oz (盎司)         | 22.9            | 27.2   | 31.9 | 37.0   | 26.6            | 29.5   | 36.8   | 46.1   | 38.3            | 44.5 | 51.0   | 58.1   |
| 注射速率                       | Injection rate(PS)            | g/s             | 264             | 314    | 369  | 427    | 251             | 278    | 347    | 434    | 326             | 378  | 434    | 494    |
| 螺杆直径                       | Screw diameter                | mm              | 55              | 60     | 65   | 70     | 57              | 60     | 67     | 75     | 65              | 70   | 75     | 80     |
| 注射压力                       | Injection pressure            | MPa             | 221             | 186    | 158  | 137    | 233             | 210    | 168    | 134    | 224             | 193  | 168    | 148    |
| 螺杆长径比                      | Screw L/D ratio               | —               | 26:1            | 23.8:1 | 22:1 | 20.4:1 | 26.5:1          | 25.2:1 | 22.5:1 | 20.1:1 | 23.7:1          | 22:1 | 20.5:1 | 19.1:1 |
| 螺杆行程                       | Screw stroke                  | mm              | 300             |        |      |        | 325             |        |        |        | 360             |      |        |        |
| 螺杆转速                       | Screw speed                   | r/ min          | 0 ~ 245         |        |      |        | 0 ~ 178         |        |        |        | 0 ~ 152         |      |        |        |
| <b>合模装置 CLAMPING UNIT</b>  |                               |                 |                 |        |      |        |                 |        |        |        |                 |      |        |        |
| 锁模力                        | Clamping force                | kN              | 3100            |        |      |        | 3200            |        |        |        | 3800            |      |        |        |
| 移模行程                       | Mold opening stroke           | mm              | 600             |        |      |        | 670             |        |        |        | 680             |      |        |        |
| 模板尺寸                       | Platen size                   | mm              | 975 × 925       |        |      |        | 960 × 960       |        |        |        | 1010 × 1010     |      |        |        |
| 拉杆内间距                      | Dist. between tie bars (HxV)  | mm              | 680 × 630       |        |      |        | 680 × 680       |        |        |        | 710 × 710       |      |        |        |
| 模板最大距离                     | Max.daylight                  | mm              | 1250            |        |      |        | 1340            |        |        |        | 1390            |      |        |        |
| 容模量(最小—最大)                 | Mold thickness(Min—Max)       | mm              | 250 ~ 650       |        |      |        | 250 ~ 670       |        |        |        | 250 ~ 710       |      |        |        |
| 顶出行程                       | Ejector stroke                | mm              | 160             |        |      |        | 160             |        |        |        | 160             |      |        |        |
| 顶出力                        | Ejector tonnage               | kN              | 77              |        |      |        | 77              |        |        |        | 111             |      |        |        |
| <b>动力/电热 POWER UNIT</b>    |                               |                 |                 |        |      |        |                 |        |        |        |                 |      |        |        |
| 油压系统压力                     | Hydraulic system pressure     | MPa             | 17.5            |        |      |        | 17.5            |        |        |        | 17.5            |      |        |        |
| 油泵马达                       | Pump motor power              | kW              | 50.2            |        |      |        | 50.2            |        |        |        | 64.6            |      |        |        |
| 电热功率                       | Heater power                  | kW              | 30              |        |      |        | 31              |        |        |        | 31.8            |      |        |        |
| 温度控制区数                     | Number of temp control zones  | —               | 6               |        |      |        | 6               |        |        |        | 6               |      |        |        |
| <b>其它 OTHERS</b>           |                               |                 |                 |        |      |        |                 |        |        |        |                 |      |        |        |
| 油箱容积                       | Oil tank                      | L (升)           | 475             |        |      |        | 380             |        |        |        | 460             |      |        |        |
| 外形尺寸 (L x W x H)           | Machine dimension (L x W x H) | m               | 6.6 × 1.8 × 2.4 |        |      |        | 6.8 × 1.8 × 2.4 |        |        |        | 7.1 × 1.9 × 2.4 |      |        |        |
| 机器重量                       | Machine weight                | Ton             | 11.5            |        |      |        | 12              |        |        |        | 13.5            |      |        |        |

## 机器尺寸/MACHINE DIMENSION

|   | HMD310M8-SII | HMD320M8-SII | HMD380M8-SII |
|---|--------------|--------------|--------------|
| A | 2013         | 2110         | 2000         |
| B | 6615         | 6789         | 7135         |
| C | 6676         | 7051         | 7300         |
| D | 2432         | 2413         | 2400         |
| E | 1800         | 1845         | 1905         |

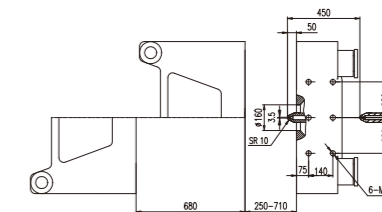
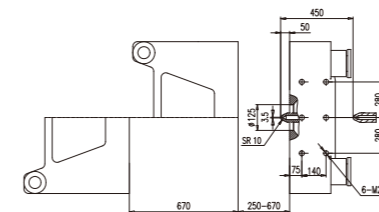
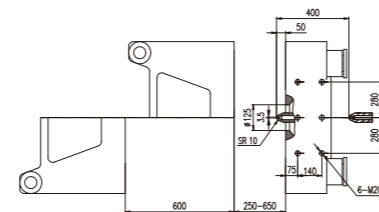
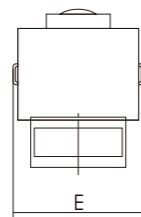
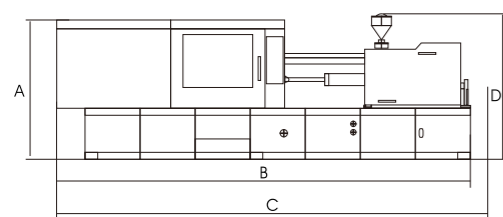
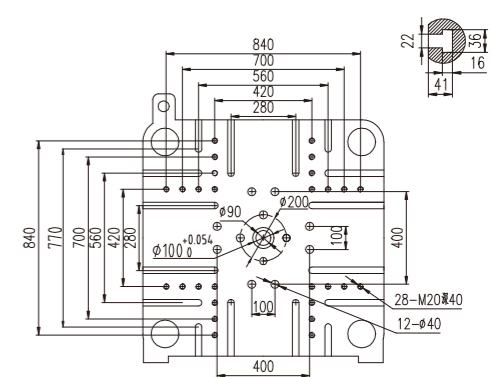
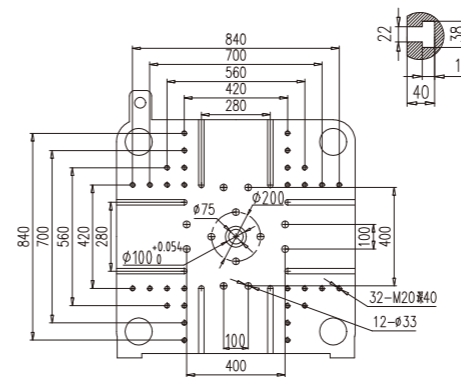
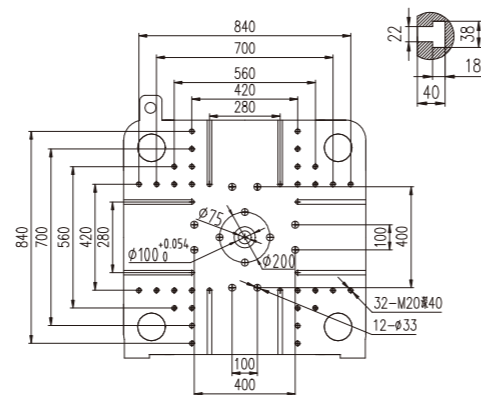





# 技术参数表 SPECIFICATIONS

| 参数                  | PARAMETER                        | UNIT            | HMD1000M8-SII    |        |        |        | HMD1100M8-SII    |        |        |        | HMD1300M8-SII    |        |       |        |
|---------------------|----------------------------------|-----------------|------------------|--------|--------|--------|------------------|--------|--------|--------|------------------|--------|-------|--------|
|                     |                                  |                 | 8514/1000        |        |        |        | 8514/1100        |        |        |        | 10897/1300       |        |       |        |
| 国际公认型号              | International size rating        | —               | A                | B      | C      | D      | A                | B      | C      | D      | A                | B      | C     | D      |
| 注射装置                | INJECTION UNIT                   |                 |                  |        |        |        |                  |        |        |        |                  |        |       |        |
| 理论注射容量              | Injection volume(theoretical)    | cm <sup>3</sup> | 3686             | 4503   | 5401   | 6381   | 3686             | 4503   | 5401   | 6381   | 5022             | 6024   | 7118  | 8302   |
| 注射重量                | Injection weight(PS)             | g (克)           | 3354             | 4097   | 4915   | 5807   | 3354             | 4097   | 4915   | 5807   | 4570             | 5482   | 6477  | 7555   |
|                     |                                  | oz (盎司)         | 118.3            | 144.5  | 173.4  | 204.8  | 118.3            | 144.5  | 173.4  | 204.8  | 161.2            | 193.4  | 228.5 | 266.5  |
| 注射速率                | Injection rate(PS)               | g/s             | 719              | 878    | 1053   | 1245   | 719              | 878    | 1053   | 1245   | 886              | 1063   | 1256  | 1465   |
| 螺杆直径                | Screw diameter                   | mm              | 95               | 105    | 115    | 125    | 95               | 105    | 115    | 125    | 105              | 115    | 125   | 135    |
| 注射压力                | Injection pressure               | MPa             | 231              | 189    | 158    | 134    | 231              | 189    | 158    | 134    | 217              | 181    | 153   | 132    |
| 螺杆长径比               | Screw L/D ratio                  | —               | 24.7:1           | 22.5:1 | 20.2:1 | 18.3:1 | 24.7:1           | 22.5:1 | 20.2:1 | 18.3:1 | 25.1:1           | 22.8:1 | 21:1  | 19.4:1 |
| 螺杆行程                | Screw stroke                     | mm              | 520              |        |        |        | 520              |        |        |        | 580              |        |       |        |
| 螺杆转速                | Screw speed                      | r/ min          | 0 ~ 120          |        |        |        | 0 ~ 120          |        |        |        | 0 ~ 94           |        |       |        |
| 合模装置                | CLAMPING UNIT                    |                 |                  |        |        |        |                  |        |        |        |                  |        |       |        |
| 锁模力                 | Clamping force                   | kN              | 10000            |        |        |        | 11000            |        |        |        | 13000            |        |       |        |
| 移模行程                | Mold opening stroke              | mm              | 1230             |        |        |        | 1250             |        |        |        | 1350             |        |       |        |
| 模板尺寸                | Platen size                      | mm              | 1660 × 1660      |        |        |        | 1710 × 1710      |        |        |        | 1845 × 1815      |        |       |        |
| 拉杆内间距               | Dist. between tie bars (HxV)     | mm              | 1160 × 1160      |        |        |        | 1180 × 1180      |        |        |        | 1300 × 1250      |        |       |        |
| 模板最大距离              | Max.daylight                     | mm              | 2390             |        |        |        | 2430             |        |        |        | 2700             |        |       |        |
| 容模量(最小—最大)          | Mold thickness(Min—Max)          | mm              | 450 ~ 1160       |        |        |        | 500 ~ 1180       |        |        |        | 550 ~ 1350       |        |       |        |
| 顶出行程                | Ejector stroke                   | mm              | 320              |        |        |        | 320              |        |        |        | 330              |        |       |        |
| 顶出力                 | Ejector tonnage                  | kN              | 210              |        |        |        | 210              |        |        |        | 230              |        |       |        |
| 动力/电热               | POWER UNIT                       |                 |                  |        |        |        |                  |        |        |        |                  |        |       |        |
| 油压系统压力              | Hydraulic system pressure        | MPa             | 17.5             |        |        |        | 17.5             |        |        |        | 17.5             |        |       |        |
| 油泵马达                | Pump motor power                 | kW              | 76+64.6          |        |        |        | 64.6+36.5+36.5   |        |        |        | 64.6+64.6+36.5   |        |       |        |
| 电热功率                | Heater power                     | kW              | 67.4             |        |        |        | 67.4             |        |        |        | 79.3             |        |       |        |
| 温度控制区数              | Number of temp control zones     | —               | 7                |        |        |        | 7                |        |        |        | 7                |        |       |        |
| 其它                  | OTHERS                           |                 |                  |        |        |        |                  |        |        |        |                  |        |       |        |
| 油箱容积                | Oil tank                         | L (升)           | 1140             |        |        |        | 1370             |        |        |        | 1350             |        |       |        |
| 外形尺寸<br>(L x W x H) | Machine dimension<br>(L x W x H) | m               | 11.9 × 2.8 × 3.3 |        |        |        | 12.8 × 2.8 × 3.4 |        |        |        | 12.5 × 3.0 × 3.5 |        |       |        |
| 机器重量                | Machine weight                   | Ton             | 47               |        |        |        | 49               |        |        |        | 61               |        |       |        |

## 机器尺寸/MACHINE DIMENSION

|   | HMD1000M8-SII | HMD1100M8-SII | HMD1300M8-SII |
|---|---------------|---------------|---------------|
| A | 2490          | 2412          | 2567          |
| B | 11105         | 11765         | 12596         |
| C | 11920         | 12765         | 13011         |
| D | 3340          | 3405          | 3497          |
| E | 2750          | 2810          | 2980          |

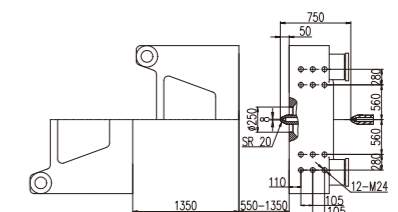
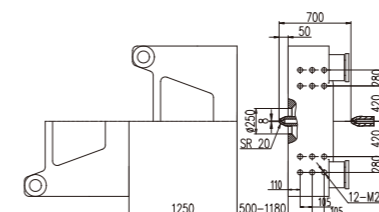
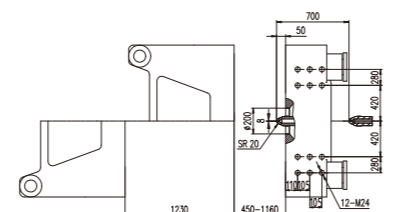
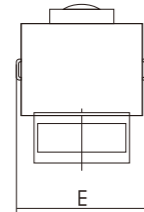
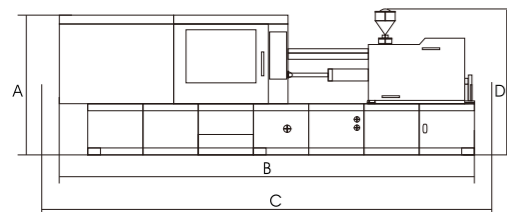
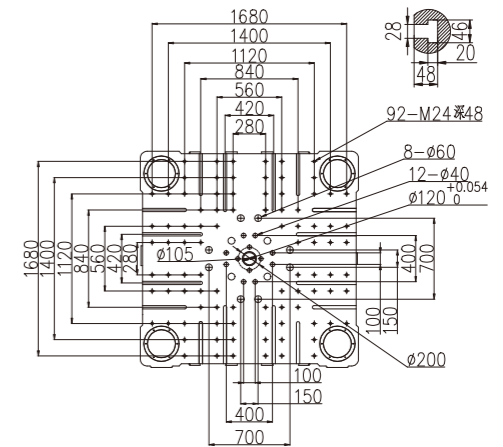
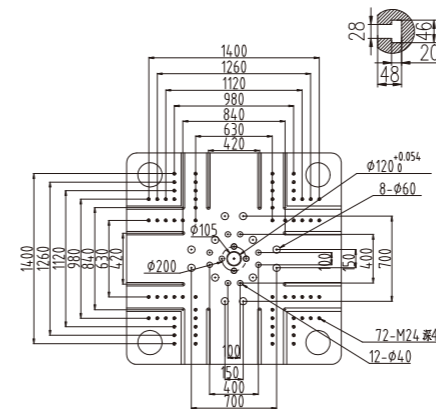
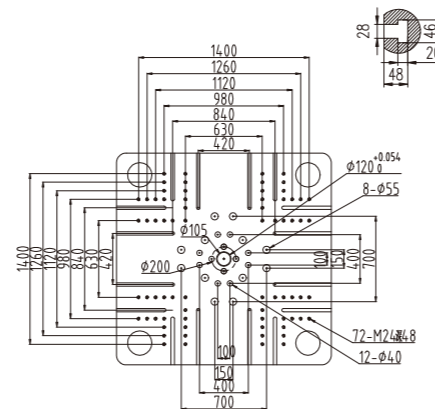

# 技术参数表 SPECIFICATIONS

| 参数               | PARAMETER                     | UNIT            | HMD1500M8-SII    |        |        |        | HMD1700M8-SII    |        |       |        |                  |        |       |        |
|------------------|-------------------------------|-----------------|------------------|--------|--------|--------|------------------|--------|-------|--------|------------------|--------|-------|--------|
|                  |                               |                 | 13087/1500       |        |        |        | 15069/1700       |        |       |        | 19232/1700       |        |       |        |
| 国际公认型号           | International size rating     | —               | A                | B      | C      | D      | A                | B      | C     | D      | A                | B      | C     | D      |
| <b>注射装置</b>      | <b>INJECTION UNIT</b>         |                 |                  |        |        |        |                  |        |       |        |                  |        |       |        |
| 理论注射容量           | Injection volume(theoretical) | cm <sup>3</sup> | 6232             | 7360   | 8588   | 9908   | 7351             | 8628   | 10006 | 11486  | 9291             | 10776  | 12370 | 14074  |
| 注射重量             | Injection weight(PS)          | g (克)           | 5671             | 6700   | 7815   | 9016   | 6690             | 7851   | 9105  | 10453  | 8455             | 9806   | 11257 | 12808  |
|                  |                               | oz (盎司)         | 200              | 236.3  | 275.7  | 318    | 236              | 276.9  | 321.2 | 368.7  | 298.2            | 345.9  | 397.1 | 451.8  |
| 注射速率             | Injection rate(PS)            | g/s             | 1045             | 1234   | 1440   | 1661   | 1070             | 1256   | 1457  | 1672   | 1156             | 1341   | 1539  | 1751   |
| 螺杆直径             | Screw diameter                | mm              | 115              | 125    | 135    | 145    | 120              | 130    | 140   | 150    | 130              | 140    | 150   | 160    |
| 注射压力             | Injection pressure            | MPa             | 210              | 177    | 152    | 132    | 205              | 174    | 150   | 131    | 207              | 179    | 156   | 137    |
| 螺杆长径比            | Screw L/D ratio               | —               | 24.2:1           | 22.3:1 | 20.6:1 | 19.2:1 | 23.3:1           | 22.6:1 | 20:1  | 18.7:1 | 24.3:1           | 22.5:1 | 21:1  | 19.7:1 |
| 螺杆行程             | Screw stroke                  | mm              | 600              |        |        |        | 650              |        |       |        | 700              |        |       |        |
| 螺杆转速             | Screw speed                   | r/ min          | 0 ~ 95           |        |        |        | 0 ~ 85           |        |       |        | 0 ~ 90           |        |       |        |
| <b>合模装置</b>      | <b>CLAMPING UNIT</b>          |                 |                  |        |        |        |                  |        |       |        |                  |        |       |        |
| 锁模力              | Clamping force                | kN              | 15000            |        |        |        | 17000            |        |       |        | 17000            |        |       |        |
| 移模行程             | Mold opening stroke           | mm              | 1550             |        |        |        | 1700             |        |       |        | 1700             |        |       |        |
| 模板尺寸             | Platen size                   | mm              | 2060 × 1960      |        |        |        | 2225 × 2095      |        |       |        | 2225 × 2095      |        |       |        |
| 拉杆内间距            | Dist. between tie bars (HxV)  | mm              | 1460 × 1360      |        |        |        | 1560 × 1430      |        |       |        | 1560 × 1430      |        |       |        |
| 模板最大距离           | Max.daylight                  | mm              | 2950             |        |        |        | 3300             |        |       |        | 3300             |        |       |        |
| 容模量 (最小—最大)      | Mold thickness(Min—Max)       | mm              | 700 ~ 1400       |        |        |        | 700 ~ 1600       |        |       |        | 700 ~ 1600       |        |       |        |
| 顶出行程             | Ejector stroke                | mm              | 350              |        |        |        | 400              |        |       |        | 400              |        |       |        |
| 顶出力              | Ejector tonnage               | kN              | 330              |        |        |        | 330              |        |       |        | 330              |        |       |        |
| <b>动力/电热</b>     | <b>POWER UNIT</b>             |                 |                  |        |        |        |                  |        |       |        |                  |        |       |        |
| 油压系统压力           | Hydraulic system pressure     | MPa             | 17.5             |        |        |        | 17.5             |        |       |        | 17.5             |        |       |        |
| 油泵马达             | Pump motor power              | kW              | 64.6+64.6+64.6   |        |        |        | 64.6+64.6+64.6   |        |       |        | 64.6+64.6+76     |        |       |        |
| 电热功率             | Heater power                  | kW              | 82.3             |        |        |        | 98.1             |        |       |        | 100              |        |       |        |
| 温度控制区数           | Number of temp control zones  | —               | 8                |        |        |        | 8                |        |       |        | 8                |        |       |        |
| <b>其它</b>        | <b>OTHERS</b>                 |                 |                  |        |        |        |                  |        |       |        |                  |        |       |        |
| 油箱容积             | Oil tank                      | L (升)           | 1800             |        |        |        | 2200             |        |       |        | 2200             |        |       |        |
| 外形尺寸 (L x W x H) | Machine dimension (L x W x H) | m               | 13.8 × 3.0 × 3.7 |        |        |        | 16.0 × 3.2 × 3.6 |        |       |        | 16.0 × 3.2 × 3.6 |        |       |        |
| 机器重量             | Machine weight                | Ton             | 87               |        |        |        | 103              |        |       |        | 105              |        |       |        |

## 机器尺寸/MACHINE DIMENSION

|   | HMD1500M8-SII | HMD1700M8-SII |
|---|---------------|---------------|
| A | 2655          | 2690          |
| B | 13229         | 14723         |
| C | 13830         | 16011         |
| D | 3671          | 3631          |
| E | 3039          | 3223          |

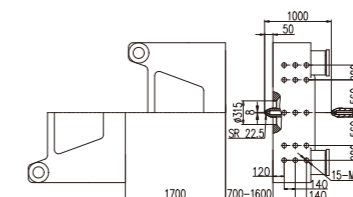
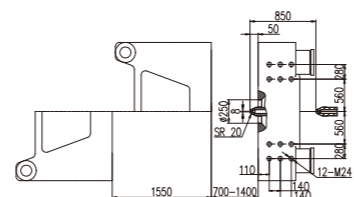
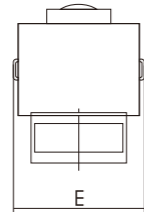
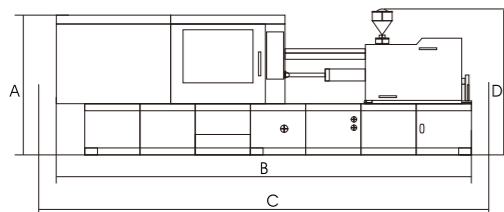
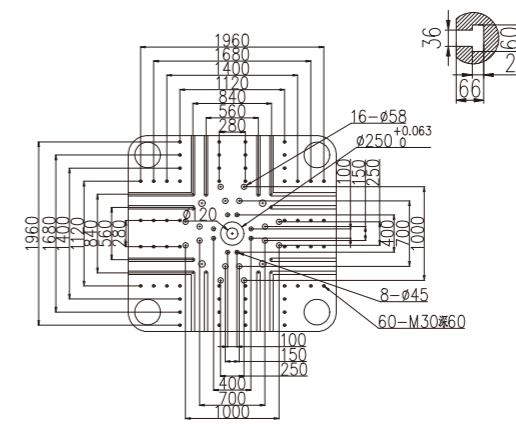
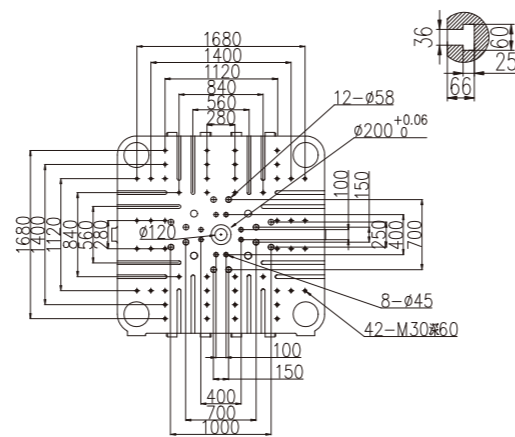



# 技术参数表 SPECIFICATIONS

| 参数              | PARAMETER                     | UNIT            | HMD2400M8-SII    |        |             |        | HMD2900M8-SII    |        |                  |        | HMD3300M8-SII    |        |                  |        |        |
|-----------------|-------------------------------|-----------------|------------------|--------|-------------|--------|------------------|--------|------------------|--------|------------------|--------|------------------|--------|--------|
|                 |                               |                 | 40000/2400       |        | 58000/2400  |        | 58000/2900       |        | 72000/2900       |        | 72000/3300       |        | 103000/3300      |        |        |
| 国际公认型号          | International size rating     | —               | A                | B      | A           | B      | A                | B      | A                | B      | A                | B      | A                | B      | C      |
| 注射装置            | INJECTION UNIT                |                 |                  |        |             |        |                  |        |                  |        |                  |        |                  |        |        |
| 理论注射容量          | Injection volume(theoretical) | cm <sup>3</sup> | 25434            | 28339  | 37680       | 41542  | 37680            | 41542  | 47493            | 51908  | 47493            | 51908  | 61073            | 66268  | 71638  |
| 注射重量            | Injection weight(PS)          | g (克)           | 23145            | 25788  | 34289       | 37803  | 34289            | 37803  | 43218            | 47236  | 43218            | 47236  | 55576            | 60304  | 65191  |
|                 |                               | oz (盎司)         | 816.4            | 909.6  | 1209.5      | 1333.5 | 1209.5           | 1333.5 | 1524.5           | 1666.2 | 1524.5           | 1666.2 | 1960.4           | 2127.1 | 2300   |
| 注射速率            | Injection rate(PS)            | g/s             | 1877             | 2091   | 2167        | 2390   | 2376             | 2620   | 2403             | 2627   | 2403             | 2627   | 2757             | 2992   | 3236   |
| 螺杆直径            | Screw diameter                | mm              | 180              | 190    | 200         | 210    | 200              | 210    | 220              | 230    | 220              | 230    | 240              | 250    | 260    |
| 注射压力            | Injection pressure            | MPa             | 156              | 140    | 154         | 139    | 154              | 139    | 152              | 139    | 152              | 139    | 169              | 156    | 144    |
| 螺杆长径比           | Screw L/D ratio               | —               | 24:1             | 22.7:1 | 21.5:1      | 20.5:1 | 21.5:1           | 20.5:1 | 21.5:1           | 20.5:1 | 21.5:1           | 20.5:1 | 23:1             | 23:1   | 22.9:1 |
| 螺杆行程            | Screw stroke                  | mm              | 1000             |        | 1200        |        | 1200             |        | 1250             |        | 1250             |        | 1350             |        |        |
| 螺杆转速            | Screw speed                   | r/ min          | 0 ~ 58           |        | 0 ~ 58      |        | 0 ~ 58           |        | 0 ~ 65           |        | 0 ~ 65           |        | 0 ~ 54           |        |        |
| 合模装置            | CLAMPING UNIT                 |                 |                  |        |             |        |                  |        |                  |        |                  |        |                  |        |        |
| 锁模力             | Clamping force                | kN              | 24000            |        |             |        | 29000            |        |                  |        | 33000            |        |                  |        |        |
| 移模行程            | Mold opening stroke           | mm              | 1980             |        |             |        | 2050             |        |                  |        | 2180             |        |                  |        |        |
| 模板尺寸            | Platen size                   | mm              | 2615 × 2480      |        |             |        | 2620 × 2520      |        |                  |        | 3150 × 2850      |        |                  |        |        |
| 拉杆内间距           | Dist. between tie bars (HxV)  | mm              | 1850 × 1650      |        |             |        | 2050 × 1750      |        |                  |        | 2250 × 1900      |        |                  |        |        |
| 模板最大距离          | Max.daylight                  | mm              | 3780             |        |             |        | 3950             |        |                  |        | 4280             |        |                  |        |        |
| 容模量(最小—最大)      | Mold thickness(Min—Max)       | mm              | 800 ~ 1800       |        |             |        | 900 ~ 1900       |        |                  |        | 1000 ~ 2100      |        |                  |        |        |
| 顶出行程            | Ejector stroke                | mm              | 480              |        |             |        | 480              |        |                  |        | 560              |        |                  |        |        |
| 顶出力             | Ejector tonnage               | kN              | 565              |        |             |        | 565              |        |                  |        | 565              |        |                  |        |        |
| 动力/电热           | POWER UNIT                    |                 |                  |        |             |        |                  |        |                  |        |                  |        |                  |        |        |
| 油压系统压力          | Hydraulic system pressure     | MPa             | 17.5             |        |             |        | 17.5             |        |                  |        | 17.5             |        |                  |        |        |
| 油泵马达            | Pump motor power              | kW              | 60+60+60+60      |        | 60+60+72+72 |        | 60+60+60+60+60   |        | 60+60+60+60+60   |        | 60+60+60+60+60   |        | 72+72+72+72+72   |        |        |
| 电热功率            | Heater power                  | kW              | 170.6            |        | 202.4       |        | 202.4            |        | 237.3            |        | 237.3            |        | 295.5            |        |        |
| 温度控制区数          | Number of temp control zones  | —               | 11               |        | 13          |        | 13               |        | 14               |        | 14               |        | 11               |        |        |
| 其它              | OTHERS                        |                 |                  |        |             |        |                  |        |                  |        |                  |        |                  |        |        |
| 油箱容积            | Oil tank                      | L (升)           | 3400             |        |             |        | 3500             |        |                  |        | 3500             |        |                  |        |        |
| 外形尺寸(L x W x H) | Machine dimension(L x W x H)  | m               | 20.4 × 4.2 × 4.0 |        |             |        | 22.0 × 4.2 × 4.2 |        | 22.5 × 4.2 × 4.2 |        | 22.8 × 4.6 × 4.6 |        | 23.0 × 4.6 × 4.7 |        |        |
| 机器重量            | Machine weight                | Ton             | 175              |        | 180         |        | 204              |        | 210              |        | 250              |        | 270              |        |        |

## 机器尺寸/MACHINE DIMENSION

|   | HMD2400M8-SII | HMD2900M8-SII | HMD3300M8-SII |
|---|---------------|---------------|---------------|
| A | 3038          | 3093          | 3635          |
| B | 19167         | 20000         | 21170         |
| C | 20367         | 22000         | 22810         |
| D | 4222          | 4245          | 4634          |
| E | 4010          | 4190          | 4610          |

